

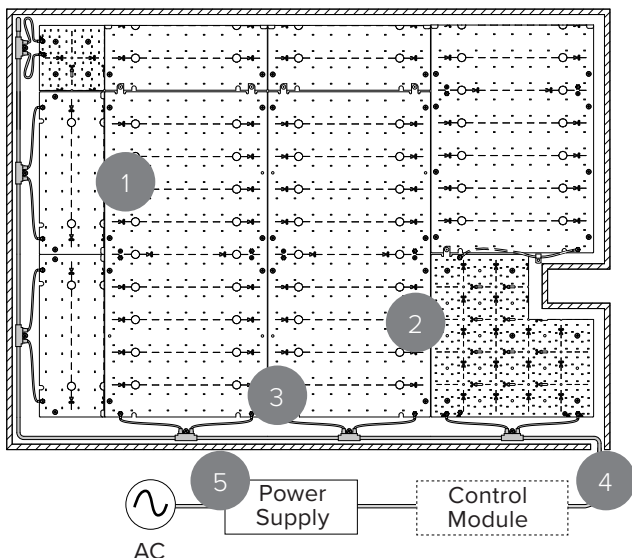

COOLEDGE cUL TILE EXTERIOR SCT R3 - SPECIFICATIONS

PROJECT		REFERENCE TYPE	
SPECIFIED BY		QUANTITY	
DATE		NOTE	For Luminous Surfaces

SYSTEM OVERVIEW



Illuminate facades, canopies, entrances (including arches & columns) and large-scale graphics

1	TILE Exterior R3
2	TILE Exterior R3 Cut-out
3	TILE T-Cable
4	TILE Exterior Starter Kit
5	Power and Control

GENERAL

Location	Damp location
Ingress Protection	IP65
Operating Temp.	-4 to 131°F
Storage Temp.	-40 to 158°F
Relative Humidity	90% max (non-condensing)
Input Voltage (to power supply)	120-277 VAC
Electrical Connections	Tool-less snap connectors
Exposure	Not to be exposed to direct sunlight, rain or snow. Intended for installation behind diffuser materials.

SPECIFICATION

cUL Listed Damp Location lighting system inclusive of flexible light emitting sheets, connectors, low voltage cables, and LED drivers. Light output from the system must be $\pm 10\%$ of 900/600/300 lumens/sqft across the total illuminated area post-installation. Color Rendering Index (CRI) must be >90 and color consistency between light sheets must be typical 3 SDCM. Electrical connections between light emitting sheets and between cables and light emitting sheets must be tool-less and allow more than one connect/ disconnect iteration. System must include the capability to accommodate obstacles, angles, and curves. System warranty is 5 years.

FEATURES

- Three choices of constant lumen output ensure consistent highly calibrated illumination
- Color consistency of typically 3 SDCM between TILES meets stringent requirements for large area installations
- Factory cutting and sealing means systems are adaptable to any size installation and can accommodate obstacles and shapes while reducing installation time and potential errors
- Constant voltage electrical architecture is fully scalable without loss of performance or need to reconfigure drivers
- Low setback distances, flexibility, and no requirement for a heat sink enable optimal integration with luminous surfaces
- Multiple options for dimming, lumen level, and CCT offer the most adaptable illumination for large surface areas available today
- Mounts directly to non-conductive construction materials (eg. drywall, plywood)

Cooledge Lighting Inc.
110-13551 Commerce Parkway
Richmond, BC V6V 2L1 Canada

O +1 604 273 2665
F +1 604 273 2660
T +1 844 455 4448
W cooledgelighting.com

Cooledge Lighting reserves the right to change materials or modify the design of its product without notification as part of the company's continuing product improvement program.

PHOTOMETRICS¹

Light Output (lm/sqft)	900, 600, 300
Correlated Color Temperature (CCT) ³	2700K, 3000K, 3500K, 4000K, 5700K
Color Rendering Index (CRI)	≥ 90
Color Uniformity	3 SDCM (typical)
Lumen Maintenance ²	L70 = 50,000hr

¹ Photometric files available from cooledgelighting.com

² Based on LM80 data & TM-21 calculations

³ CCT shown is nominal. Contact Cooledge for specific values

POWER

Light Output (lm/sqft)	CCT	Power (W/sqft)	EcoDesign Class
900	2700K	6.9	E
	3000K	6.3	D
	3500K	6.2	D
	4000K	6.2	D
	5700K	6.2	D
600	2700K	4.6	E
	3000K	4.3	E
	3500K	4.1	D
	4000K	4.1	D
	5700K	4.2	D
300	2700K	2.3	E
	3000K	2.2	E
	3500K	2.0	D
	4000K	2.1	D
	5700K	2.0	D



CERTIFICATIONS



RoHS

**UK
CA**



IP65

WARRANTY



5 Year Limited Warranty:
Parts and workmanship when
used with a Cooledge approved
power supply.

1 TILE EXTERIOR R3 = 1

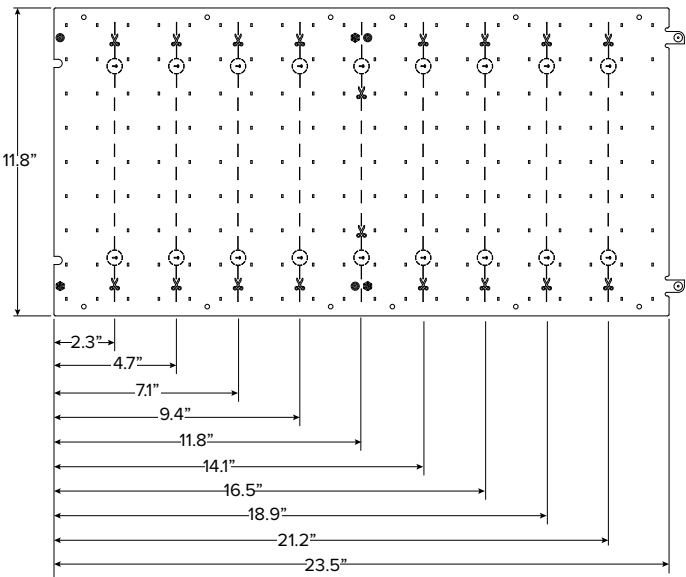

Weight = 0.18lbs/ 82g

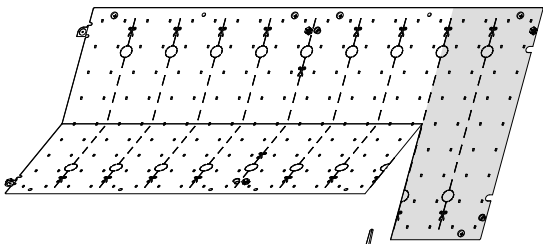

TILEs will be cut and sealed in the factory prior to shipment



HOW TO ORDER

Example: TILE-EXT-600-30-R3

TILE	-	EXT	-		-	R3
PRODUCT TILE		TYPE EXT = Exterior		FLUX 900 = 900lm/sqft 600 = 600lm/sqft 300 = 300lm/sqft		CCT 27 = 2700K 30 = 3000K 35 = 3500K 40 = 4000K 57 = 5700K
						Version R3 = Revision 3

2 TILE EXTERIOR R3 CUT-OUT KIT = 2

Purpose: Used to accommodate obstacles located in the middle of a luminous surface such as standoffs, support cables/ rods, beams, pipes, etc.; used in corners where a full TILE does not fit in the space; or to step cut along angles and curves in a luminous surface. (Optional)

INCLUDED

- (2) Cable Clamps
- (2) Jumper Cables
- (1) Cut-out Tile

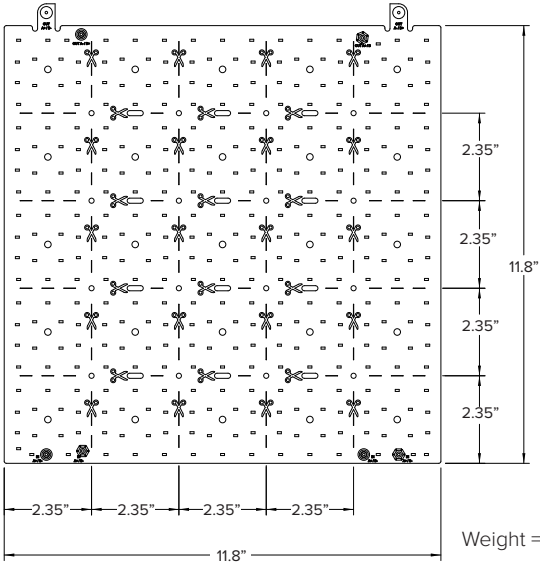
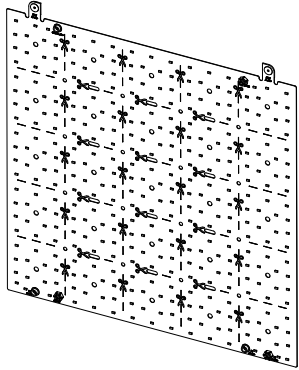

TILEs will be cut and sealed in the factory prior to shipment

Weight = 0.10lbs / 45g

HOW TO ORDER

Example: TACC-EXT-CUT-600-30-R3

TACC	-	EXT	-	CUT	-		-	R3
PRODUCT TACC = TILE Accessory		TYPE EXT = Exterior		COMPONENT CUT = Cut-out Kit		FLUX 900 = 900lm/sqft 600 = 600lm/sqft 300 = 300lm/sqft		CCT 27 = 2700K 30 = 3000K 35 = 3500K 40 = 4000K 57 = 5700K
								KIT R3 = Revision 3

3 TILE T-CABLE = 3

Purpose: Makes the electrical connection to the first TILE in each run from the Starter Cable that supplies power from the power/control components. Each “T” connects to a TILE via snap connectors. (Required)

HOW TO ORDER

Example: TCBL-SCT-T10

TCBL	-	SCT	-	CCT
PRODUCT		CCT		TYPE
TCBL = TILE Cable		SCT = Static Color Temp.		T4 = 4 T-Connectors (weight = .13lb) T10 = 10 T-Connectors (weight = .66lb)

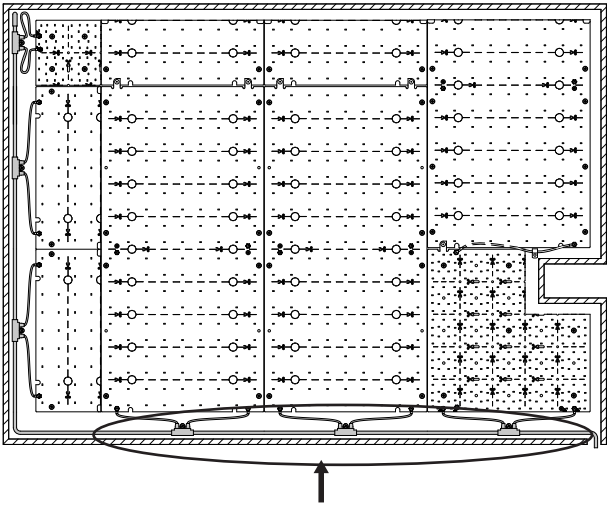

4 TILE EXTERIOR STARTER KIT = 4

Purpose: Includes the Starter Cable that makes the connection from the Power/Control components to the T-Cable and other accessories required for wire termination and connections.

INCLUDED

- (2) IP65 Splice Connectors.
- (4) End Caps
- (4) Cut TILE Reuse Jumper Cables
- (1) 16 AWG (1.3mm2) Cable, 10 ft (3m) Length
- (1) Quick Start Guide
- (6) Insulation Patches

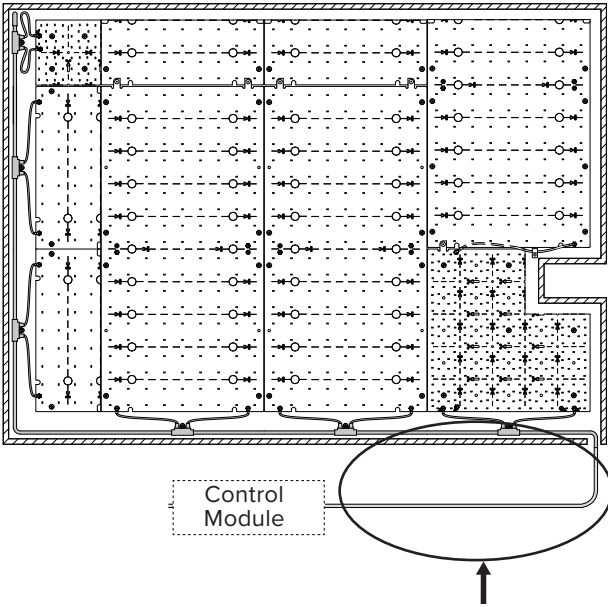
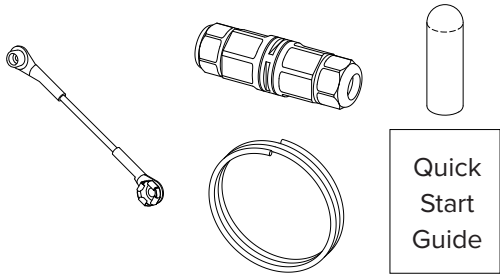

HOW TO ORDER

Example: TACC-EXT-SCT-STR

TACC	-	EXT	-	SCT	-	STR
PRODUCT		TYPE		CCT		TYPE
TACC = TILE Accessory		EXT = Exterior		SCT = Static Color Temp.		STR = Starter

5 POWER AND CONTROL = 5

Specifications for the power supplies and Cooledge Control Modules shown below are available in the following document:
- PSD-0007 cUL Listed Power and Control Specifications

The models shown below are those that are compatible with TILE Exterior R3 Systems for regions where cUL listed products are required.

POWER SUPPLIES (54V)

Purpose: Convert AC main (line) power to safe, low voltage DC power. (Required)

Order Code	Description	# Controller Channels*	Integrated Wiring Enclosure
EPSS-092-54V-UL	92W Power Supply, 54V (UL Listed) with integrated junction box	1	Yes
EPSS-200-54V-UL	200W Power Supply, 54V (UL Listed) with integrated junction box	2	Yes
EPSS-400-54V-UL	400W Power Supply, 54V (UL Listed) with integrated junction box	4	Yes

Class 2 (max. 90W) output

IP65 or higher rated enclosure for power supplies is by others

COOLEEDGE CONTROL MODULES (54V)

Purpose: Receives 54VDC power from the power supply and converts it to max. 90W per channel of controlled output to drive TILE Exterior R3 sheets. Also receives input control from one of 4 protocol options to control dimming levels. (Optional)

Order Code	Protocols
CTR-SCT-DAL/010-48/58V	0-10V, DALI
CTR-SCT-DMX-48/58V	DMX
CTR-SCT-CAS-48/58V	Casambi (wireless)

For exterior applications, Cooledge Control Modules must be mounted within an appropriate IP65 or higher UL Listed enclosure. The minimum recommended for size for the enclosure is 15.5" L x 6.5" W x 3.6" H. Please contact Cooledge Lighting for recommendations.

ADDITIONAL ACCESSORIES

EXTENSION CABLES

- 16 AWG cable (non-plenum rated)
- Available in 10' & 20' lengths

Purpose: Cable between TILE Starter Cable and Cooledge Control Module that extends the distance the Cooledge Control Module and power supply may be remotely located away from the TILES. Please consult Cooledge for additional information including requirements for plenum rated cables.

IP65 SPLICE CONNECTOR "TCBL-EXT-SPL-R"

Purpose: Connect Extension Cable to Starter Cable

